

REVISION HISTORY				
REV	DATE	DESCRIPTION	ECO	BY
A	09-18-07	INITIAL RELEASE OF PRODUCTION	11717	SJ

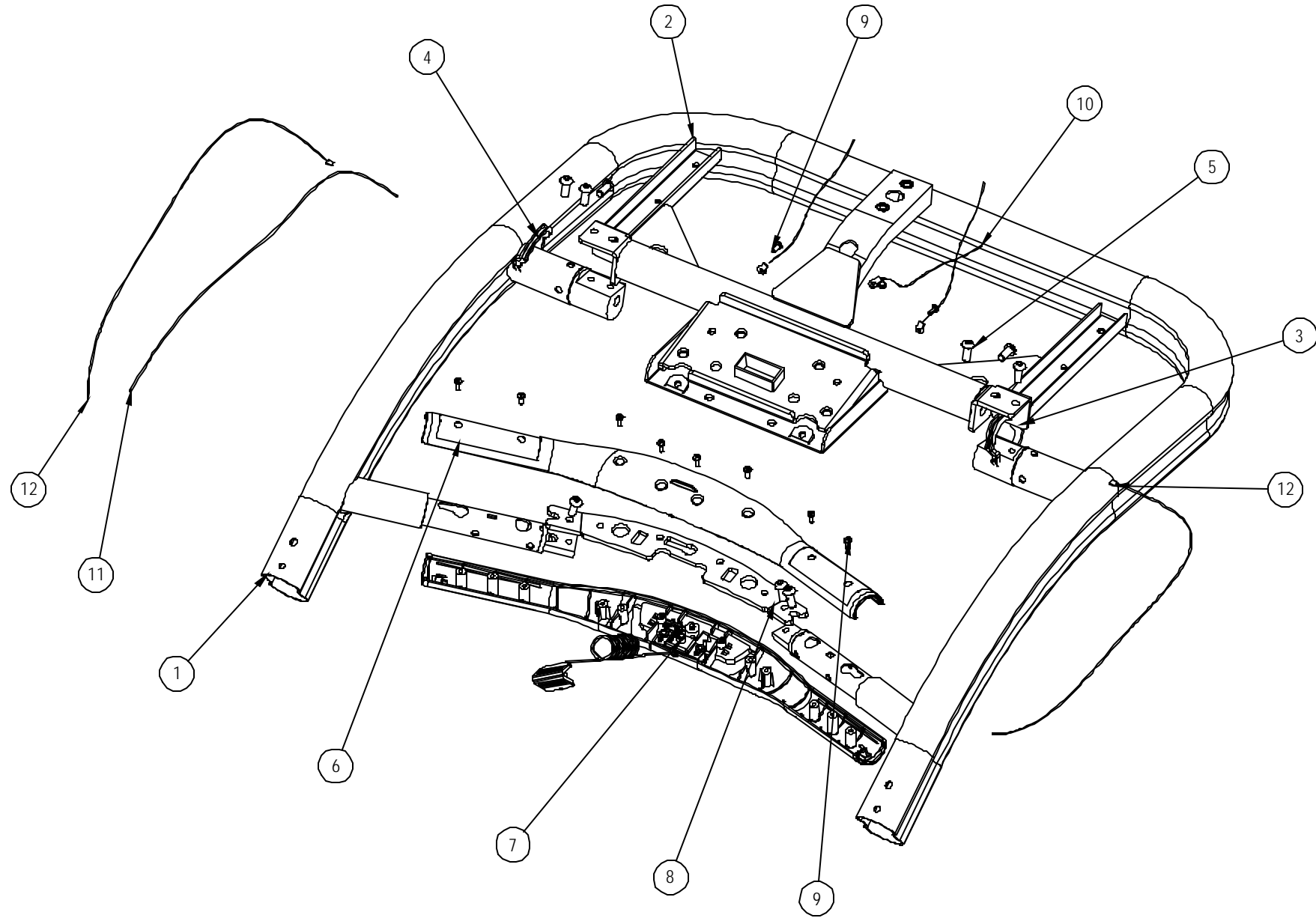

ITEM NO.	STAR TRAC P/N	INRAY P/N	DESCRIPTION	Default/ QTY.
1	740-6168	STDP0200-TR	HANRAIL, FRONT, S-TR	1
2	740-6101	STDP1600	WELDMENT, DISPLAY STRUCTURE	1
3	740-6100	STDP3310-TRC	GASKET, DISPLA-RAILS, TRC LEFT	1
4	740-6099	STDP3311-TRC	GASKET, DISPLA-RAILS, TRC, RIGHT	1
5	740-6502	PNLM8*20*20;   19	SCREW, PNLM8*20*20	9
6	740-6097	740-6097	ASSY, HOTBAR, LOWER SECTION	1
7	740-6096	STDP4000	ASSY, HOTBAR, UPPER SECTION	1
8	740-6098	STDP1500	PLATE, HOT BAR SUPPORT	1
9	740-6502	GB6560M4*12;   2	SCREW, GB6560M4*12	11
10	740-6016	740-6016	Assy, Cable, Generic GND, Sport Tread	3
11	740-6012	740-6012	Assy, Cable, Stop Switch Extension	1
12	740-6035	740-6035	Assy, Cable, CHR, Sport Tread	2

**NOTICE OF PROPRIETARY INFORMATION**  
 THIS DOCUMENT SHALL NOT BE REPRODUCED NOR SHALL THE INFORMATION CONTAINED HEREIN BE USED BY OR DISCLOSED TO OTHER EXCEPT AS EXPRESSLY AUTHORIZED BY UNISEN INC. D.B.A. STAR TRAC.

**DOCUMENT STATUS:**

NOTES:

CLASS OF WORK	UNLESS OTHERWISE SPECIFIED DIMS ARE IN mm. TOLERANCES FOR MEASURE OF LENGTH ARE:							
	0.5 to 3	>3 to 6	>6 to 30	>30 to 120	>120 to 400	>400 to 1000	>1000 to 2000	>2000
FINE	±0.05	±0.05	±0.1	±0.15	±0.2	±0.3	±0.5	-----
MEDIUM	±0.1	±0.1	±0.2	±0.3	±0.5	±0.8	±1.2	±2
COARSE	±0.2	±0.3	±0.5	±0.8	±1.2	±2	±3	±4
VERY COARSE	-----	±0.5	±1	±1.5	±2.5	±4	±6	±8

**MATERIAL**

**FINISH**

**VENDOR:**

P/N: **STDP0200-TR**

THIRD ANGLE PROJECTION



DRAWN	INITIAL	DATE
CHECKED		
APPROVED		

**UNISEN, INC. DBA**  
  
 14410 Myford Road  
 Irvine CA 92606

STARTRAC PART NO: **740-6154** REV: **A**

TITLE: **ASSY. HANRAIL & HOTBAR, S-TR**

SCALE: 1:6 | SHEET 1 OF 1 | SHEET SIZE: B